

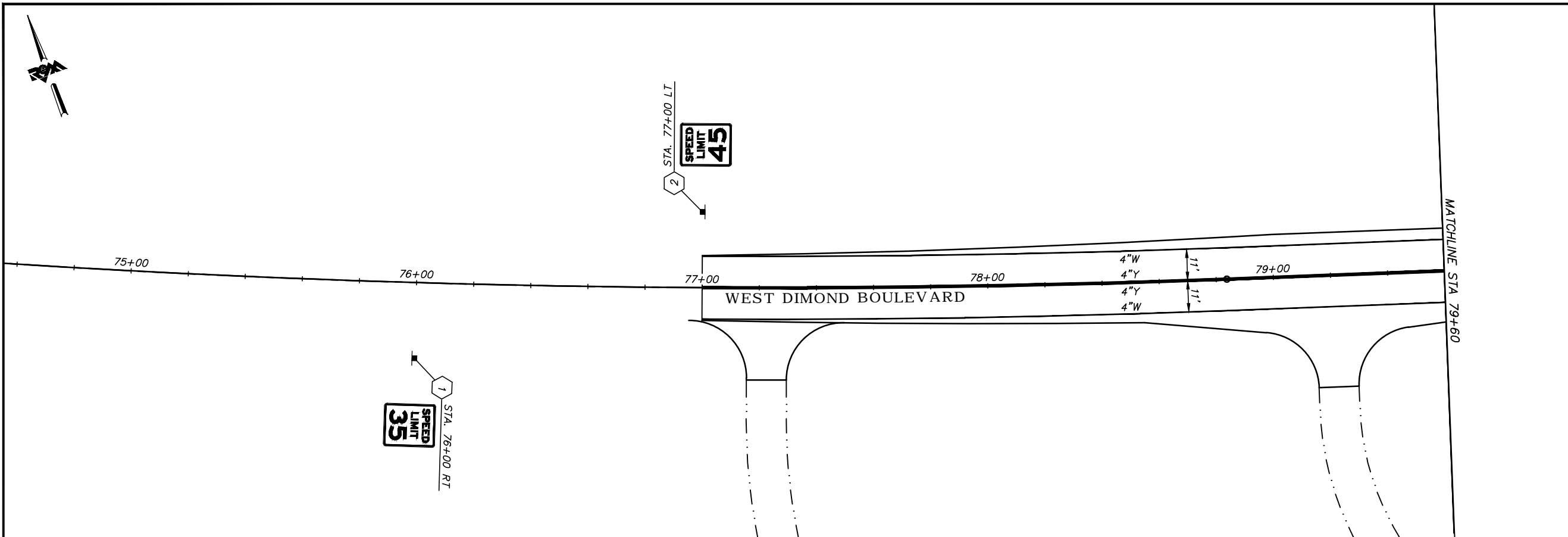

File Location: Z:\project\1317.01- West Dimond Blvd\Engineering\Acad\1317-L-Signing & Striping.dwg

Plotted: 4/11/2014 7:39 AM

**BEFORE YOU DIG
CALL FOR FREE
UNDERGROUND
LOCATION**

LOCATE CALL CENTER OF ALASKA
STATEWIDE 800-478-3121 WILL
NOTIFY SUBSCRIBED UTILITIES ONLY.
OTHER UTILITIES NEED TO BE
CONTACTED INDIVIDUALLY.

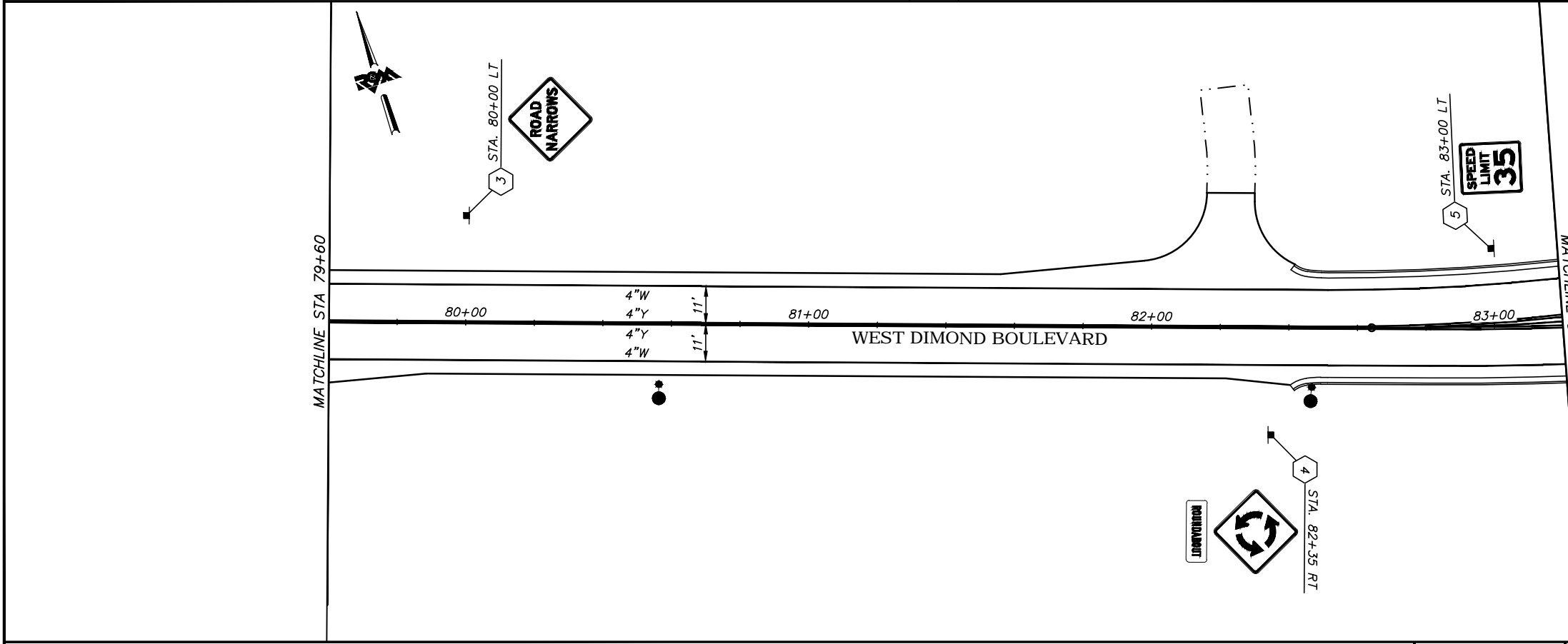
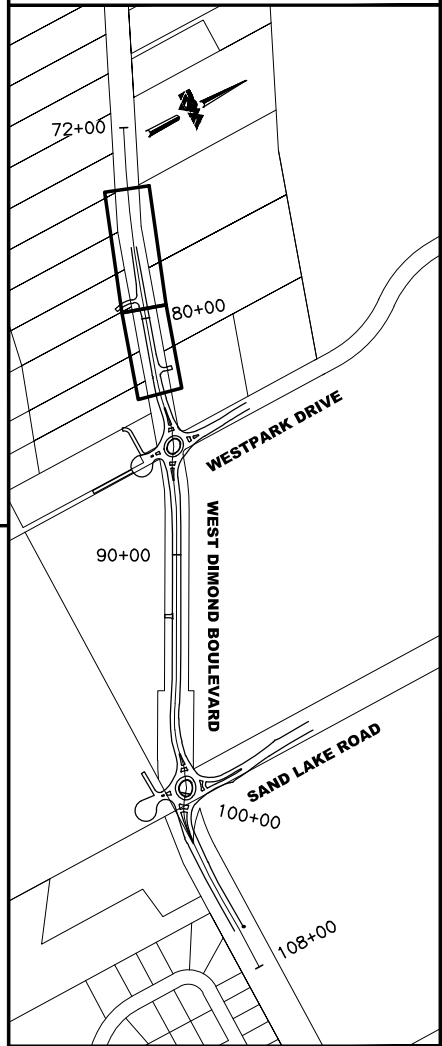

SIGNING & STRIPING NOTES:

1. FLEXIBLE DELINEATORS ARE NOT SHOWN ON THE PLANS FOR CLARITY. INSTALL AT ALL LANE REDUCTION TAPERS, BEGIN/END OF CURB, AND PLACED ACCORDING TO STANDARD DRAWING X. FINAL LOCATIONS ARE TO BE APPROVED BY THE ENGINEER PRIOR TO INSTALLATION.

**65% DESIGN
APRIL 2014**

SCALE IN FEET

FIELD BOOKS	BM NO.	LOCATION	ELEV.	DATA	DRAWN BY	CHECKED BY	DATA	DRAWN BY	CHECKED BY	REV	DATE	DESCRIPTION	BY	REV	DATE	DESCRIPTION	BY
DESIGN				BASE			TELEPHONE										
STAKING				TOPOGRAPHY			ELECTRIC										
ASBULT				PROFILE			CABLE TV										
CONTRACTOR				SANITARY SEWER			DESIGN										
INSPECTOR				STORM SEWER			QUANTITIES										
CONSTRUCTION RECORD				WATER			MUN. FINAL CHK.										
				GAS													



R&M Consultants, Inc.
9101 Vanguard Drive
Anchorage, Alaska 99507
907 522 1707 voice
907 522 3404 fax
www.rmconsult.com

SEAL



PROJECT MANAGEMENT AND
ENGINEERING DIVISION

05-05 WEST DIMOND BOULEVARD UPGRADE
PHASE I: WESTPARK DRIVE TO SAND LAKE ROAD
SIGNING & STRIPING PLAN
BOP TO STA 83+20

SCALE 1:20 H
1:4 V

DATE ACCT. NO. GRID 2323 2324
2423 2424

SHEET 62 of 76

MATCHLINE STA 211+60

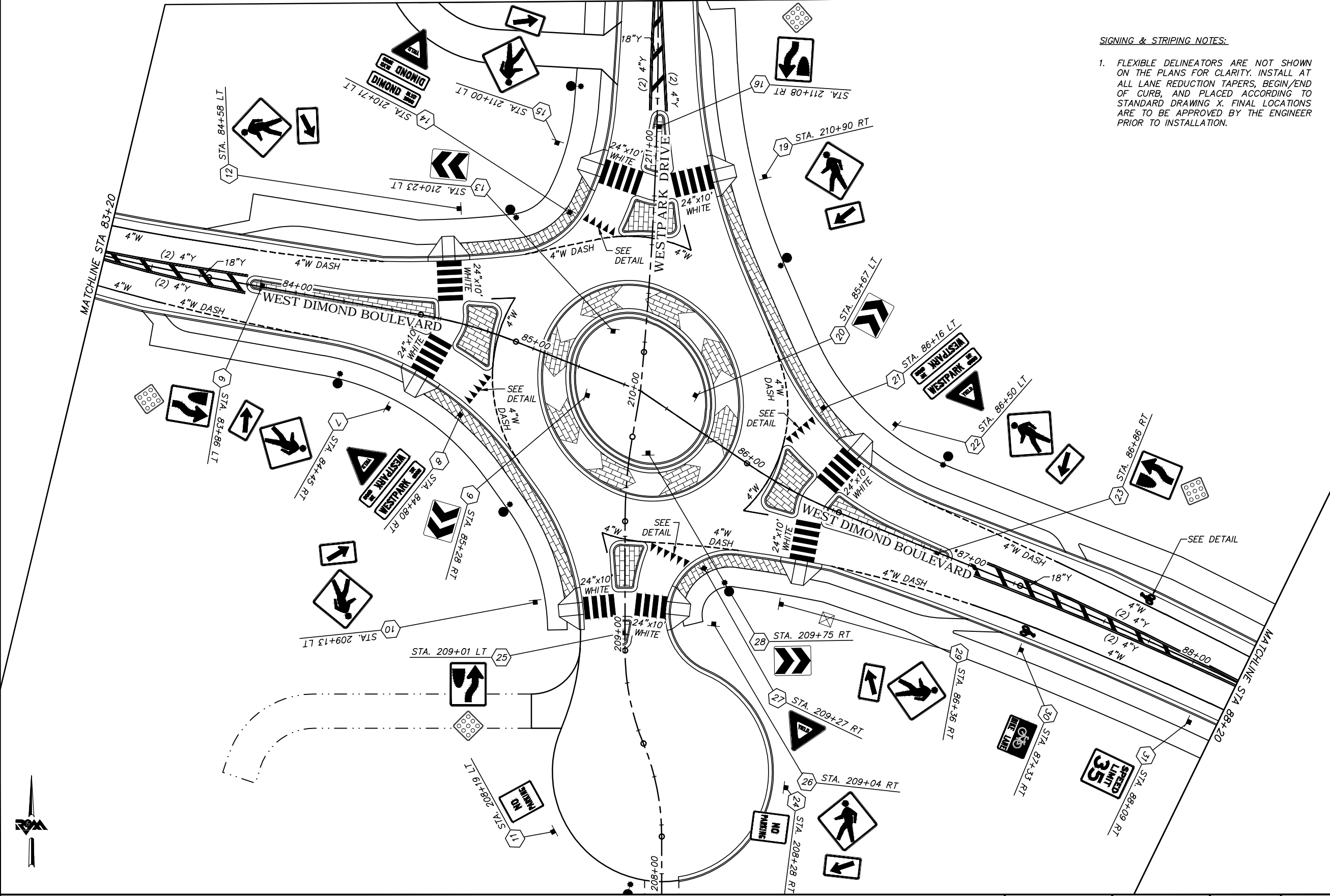

SIGNING & STRIPING NOTES:

1. FLEXIBLE DELINEATORS ARE NOT SHOWN ON THE PLANS FOR CLARITY. INSTALL AT ALL LANE REDUCTION TAPERS, BEGIN/END OF CURB, AND PLACED ACCORDING TO STANDARD DRAWING X. FINAL LOCATIONS ARE TO BE APPROVED BY THE ENGINEER PRIOR TO INSTALLATION.



**BEFORE YOU DIG
CALL FOR FREE
UNDERGROUND
LOCATION**

LOCATE CALL CENTER OF ALASKA STATEWIDE 800-478-3121 WILL NOTIFY SUBSCRIBED UTILITIES ONLY. OTHER UTILITIES NEED TO BE CONTACTED INDIVIDUALLY.

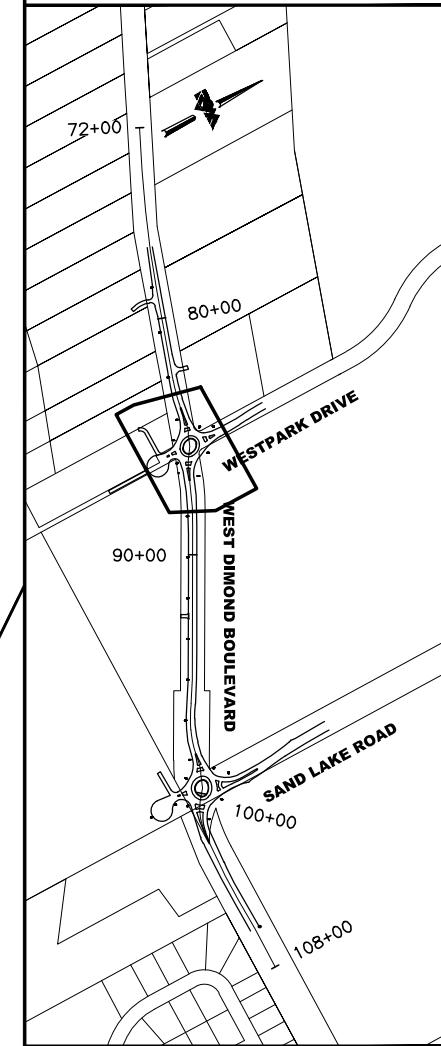

KEYMAP

**65% DESIGN
APRIL 2014**

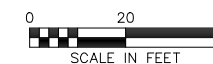

FIELD BOOKS	BM NO.	LOCATION	ELEV.	DATA	DRAWN BY	CHECKED BY	DATA	DRAWN BY	CHECKED BY	REV	DATE	DESCRIPTION	BY	REV	DATE	DESCRIPTION	BY
DESIGN				BASE			TELEPHONE										
STAKING				TOPOGRAPHY			ELECTRIC										
ASBUILT				PROFILE			CABLE TV										
CONTRACTOR				SANITARY SEWER			DESIGN										
INSPECTOR				STORM SEWER			QUANTITIES										
CONSTRUCTION RECORD				WATER			MUN. FINAL CHK.										
				GAS													
				PLAN CHECK													

R&M Consultants, Inc.
9101 Vanguard Drive
Anchorage, Alaska 99507
907 522 1707 voice
907 522 3404 fax
www.rmconsult.com

SEAL



PROJECT MANAGEMENT AND ENGINEERING DIVISION	
05-05	WEST DIMOND BOULEVARD UPGRADE PHASE I: WESTPARK DRIVE TO SAND LAKE ROAD SIGNING & STRIPING PLAN WESTPARK ROUNDABOUT
SCALE 1:20 1:54	DATE ACCT. NO.
GRID 2323 2324 2423 2424	SHEET 63 of 76

File Location: Z:\project\1317.01 - West Dimond Blvd\Engineering\Acad\1317-L-Signing & Striping.dwg

Plotted: 4/11/2014 7:40 AM



**BEFORE YOU DIG
CALL FOR FREE
UNDERGROUND
LOCATION**

LOCATE CALL CENTER OF ALASKA
STATEWIDE 800-478-3121 WILL
NOTIFY SUBSCRIBED UTILITIES ONLY.
OTHER UTILITIES NEED TO BE
CONTACTED INDIVIDUALLY.

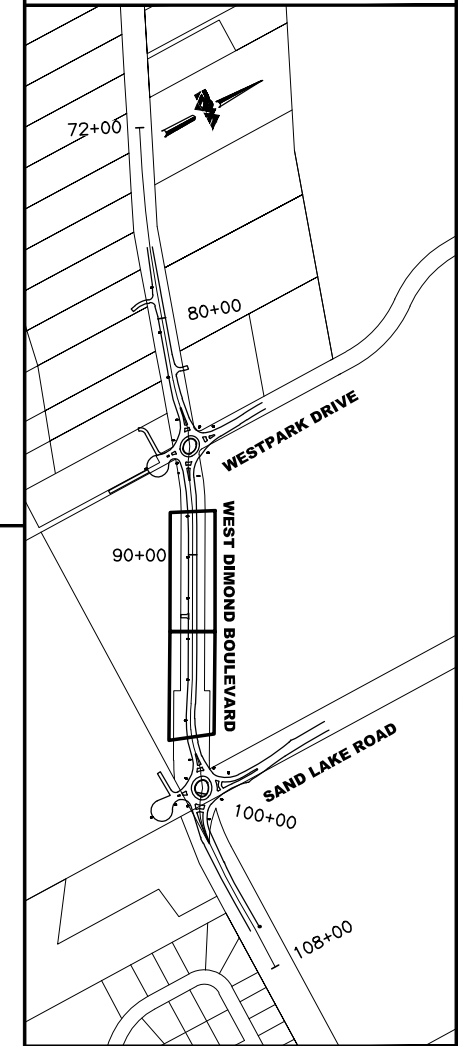
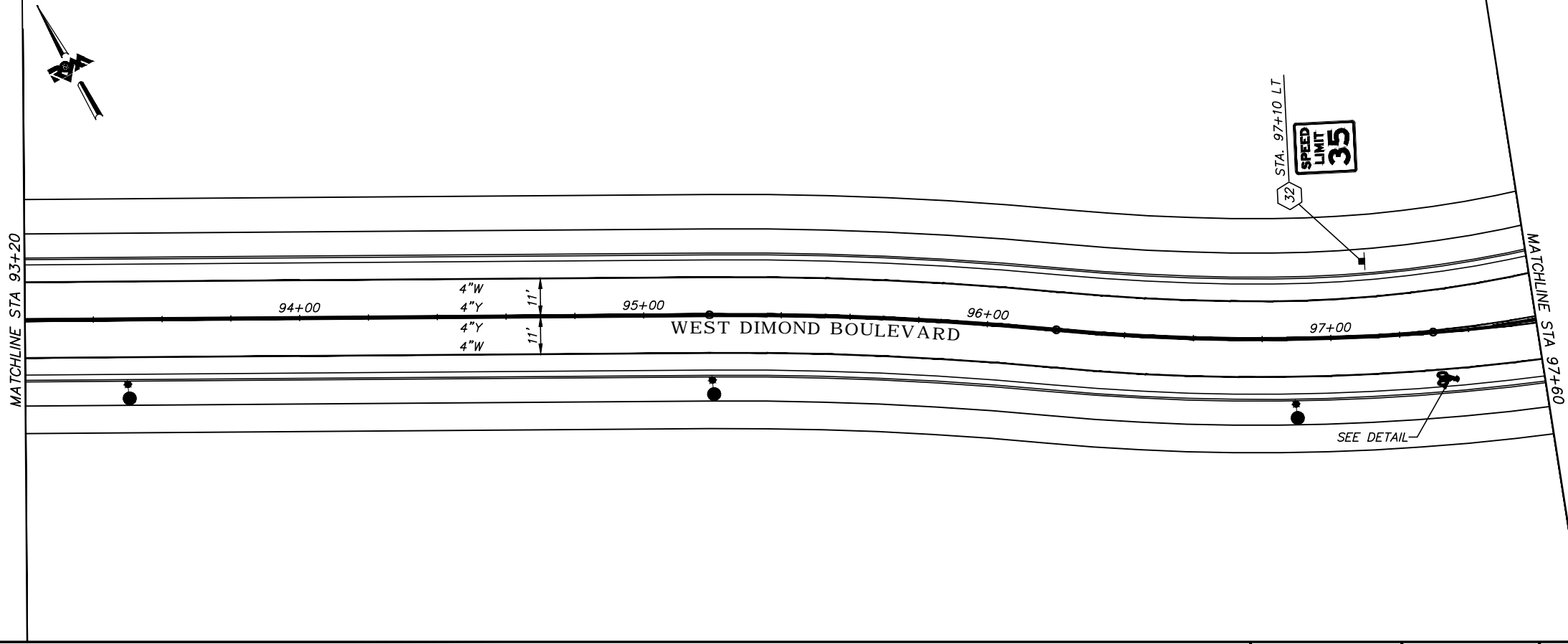
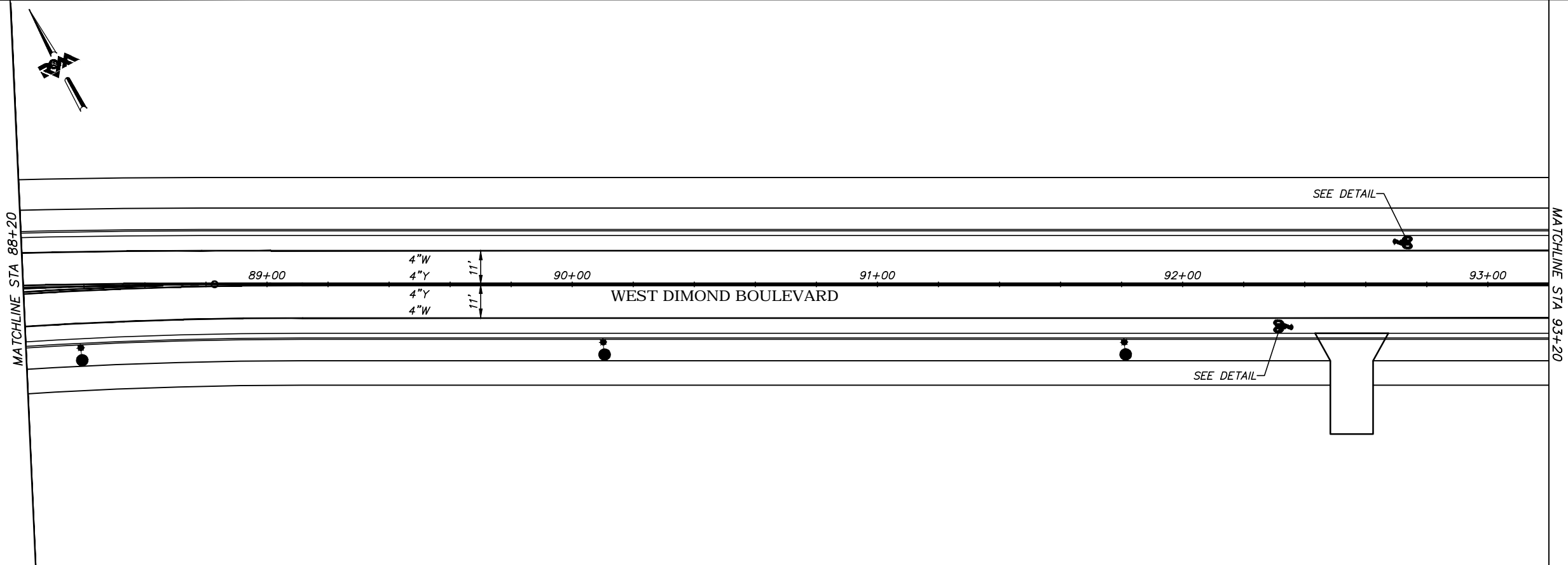

KEYMAP

**65% DESIGN
APRIL 2014**



FIELD BOOKS	BM NO.	LOCATION	ELEV.	DATA	DRAWN BY	CHECKED BY	DATA	DRAWN BY	CHECKED BY	REV	DATE	DESCRIPTION	BY	REV	DATE	DESCRIPTION	BY
DESIGN				BASE			TELEPHONE										
STAKING				TOPOGRAPHY			ELECTRIC										
ASBUILT				PROFILE			CABLE TV										
CONTRACTOR				SANITARY SEWER			DESIGN										
INSPECTOR				STORM SEWER			QUANTITIES										
CONSTRUCTION RECORD				WATER			MUN. FINAL CHK.										
				GAS													

R&M Consultants, Inc.
9101 Vanguard Drive
Anchorage, Alaska 99507
907 522 1707 voice
907 522 3404 fax
www.rmconsult.com

SEAL



PROJECT MANAGEMENT AND
ENGINEERING DIVISION

05-05 WEST DIMOND BOULEVARD UPGRADE
PHASE I: WESTPARK DRIVE TO SAND LAKE ROAD
SIGNING & STRIPING PLAN
STA 88+20 TO STA 97+60

SCALE 1:20 H
1:4 V DATE ACCT. NO. GRID 2323 2324
2423 2424 SHEET 64 of 76

File Location: Z:\project\1317.01 - West Dimond Blvd\Engineering\Acad\1317-L-Signing & Striping.dwg

Plotted: 4/11/2014 7:40 AM

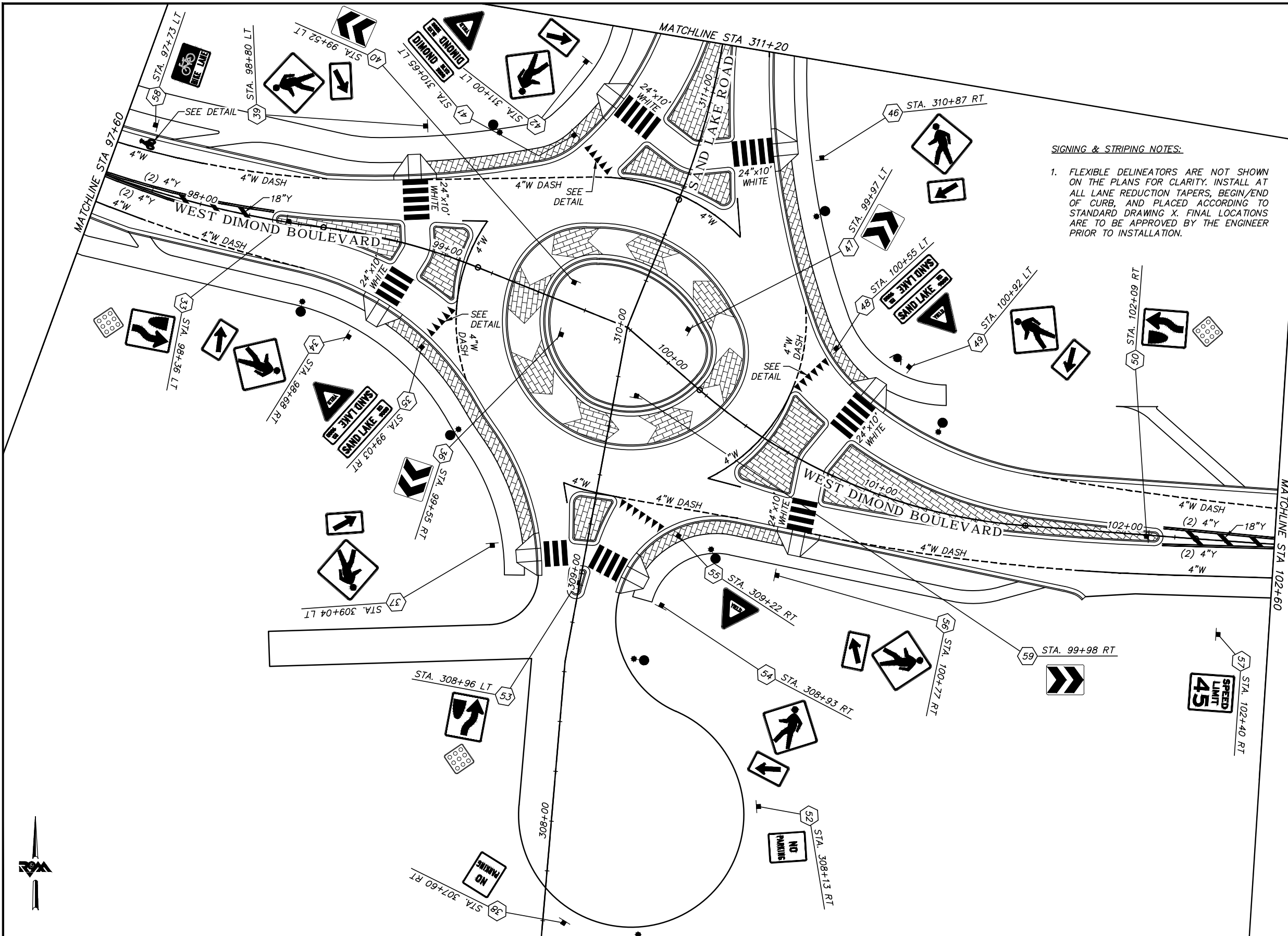

SIGNING & STRIPING NOTES:

1. FLEXIBLE DELINEATORS ARE NOT SHOWN ON THE PLANS FOR CLARITY. INSTALL AT ALL LANE REDUCTION TAPERS, BEGIN/END OF CURB, AND PLACED ACCORDING TO STANDARD DRAWING X. FINAL LOCATIONS ARE TO BE APPROVED BY THE ENGINEER PRIOR TO INSTALLATION.



**BEFORE YOU DIG
CALL FOR FREE
UNDERGROUND
LOCATION**

LOCATE CALL CENTER OF ALASKA
STATEWIDE 800-478-3121 WILL
NOTIFY SUBSCRIBED UTILITIES ONLY.
OTHER UTILITIES NEED TO BE
CONTACTED INDIVIDUALLY.

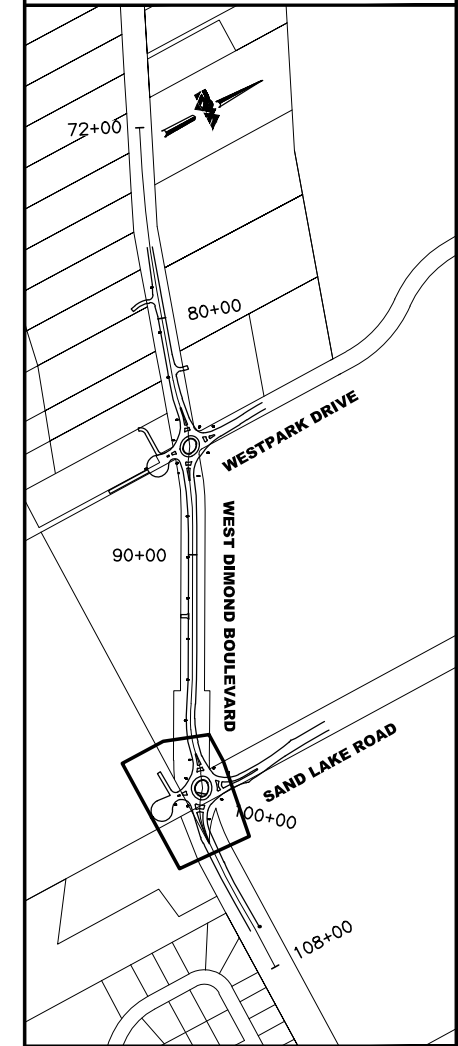

**65% DESIGN
APRIL 2014**

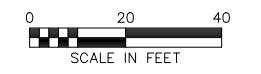

FIELD BOOKS	BM NO.	LOCATION	ELEV.	DATA	DRAWN BY	CHECKED BY	DATA	DRAWN BY	CHECKED BY	REV	DATE	DESCRIPTION	BY	REV	DATE	DESCRIPTION	BY	
DESIGN				BASE			TELEPHONE											
STAKING				TOPOGRAPHY			ELECTRIC											
ASBUILT				PROFILE			CABLE TV											
CONTRACTOR				SANITARY SEWER			DESIGN											
INSPECTOR				STORM SEWER			QUANTITIES											
CONSTRUCTION RECORD				WATER			MUN. FINAL CHK.											
				GAS														

R&M Consultants, Inc.
9101 Vanguard Drive
Anchorage, Alaska 99507
907 522 1707 voice
907 522 3404 fax
www.rmconsult.com

CONSULTANT

SEAL



PROJECT MANAGEMENT AND ENGINEERING DIVISION	
05-05	WEST DIMOND BOULEVARD UPGRADE PHASE I: WESTPARK DRIVE TO SAND LAKE ROAD SIGNING & STRIPING PLAN SAND LAKE ROUNDABOUT
SCALE 1:20 1:54	DATE ACCT. NO.
GRID 2323 2324 2423 2424	SHEET 65 of 76

File Location: Z:\project\1317.01- West Dimond Blvd\Engineering\Acad\1317-L-Signing & Striping.dwg

Plotted: 4/11/2014 7:40 AM

MATCHLINE STA 102+60

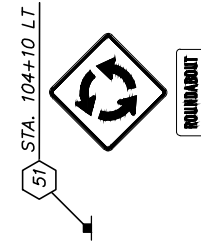

SIGNING & STRIPING NOTES:

1. FLEXIBLE DELINEATORS ARE NOT SHOWN ON THE PLANS FOR CLARITY. INSTALL AT ALL LANE REDUCTION TAPERS, BEGIN/END OF CURB, AND PLACED ACCORDING TO STANDARD DRAWING X. FINAL LOCATIONS ARE TO BE APPROVED BY THE ENGINEER PRIOR TO INSTALLATION.



**BEFORE YOU DIG
CALL FOR FREE
UNDERGROUND
LOCATION**

LOCATE CALL CENTER OF ALASKA STATEWIDE 800-478-3121 WILL NOTIFY SUBSCRIBED UTILITIES ONLY. OTHER UTILITIES NEED TO BE CONTACTED INDIVIDUALLY.

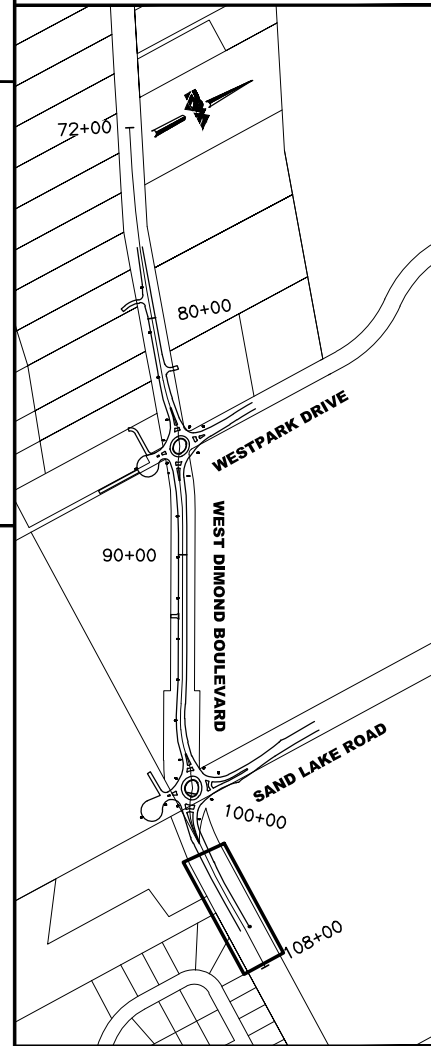
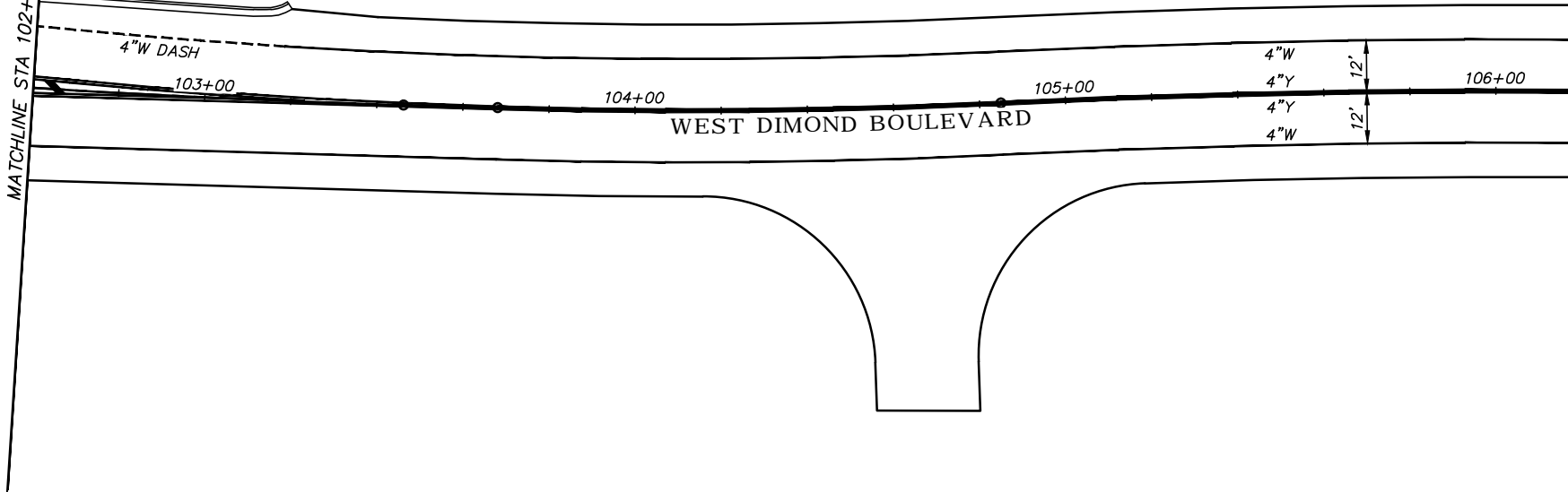

KEYMAP

**65% DESIGN
APRIL 2014**

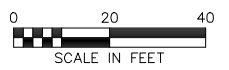

FIELD BOOKS	BM NO.	LOCATION	ELEV.	DATA	DRAWN BY	CHECKED BY	DATA	DRAWN BY	CHECKED BY	REV	DATE	DESCRIPTION	BY	REV	DATE	DESCRIPTION	BY						
				BASE			TELEPHONE																
				TOPOGRAPHY			ELECTRIC																
				PROFILE			CABLE TV																
				SANITARY SEWER			DESIGN																
				STORM SEWER			QUANTITIES																
				WATER			MUN. FINAL CHK.																
				GAS																			
CONSTRUCTION RECORD				VERTICAL DATUM				PLAN CHECK				REVISIONS				CONSULTANT				SEAL			

R&M Consultants, Inc.
9101 Vanguard Drive
Anchorage, Alaska 99507
907 522 1707 voice
907 522 3404 fax
www.rmconsult.com



PROJECT MANAGEMENT AND ENGINEERING DIVISION

05-05 WEST DIMOND BOULEVARD UPGRADE
PHASE I: WESTPARK DRIVE TO SAND LAKE ROAD
SIGNING & STRIPING PLAN
STA 102+60 TO EOP

SCALE 1:20 H
1:4 V

DATE ACCT. NO.

GRID 2323 2324
2423 2424

SHEET 66 of 76

SIGNING & STRIPING NOTES:

- 1. FLEXIBLE DELINEATORS ARE NOT SHOWN ON THE PLANS FOR CLARITY. INSTALL AT ALL LANE REDUCTION TAPERS, BEGIN/END OF CURB, AND PLACED ACCORDING TO STANDARD DRAWING X. FINAL LOCATIONS ARE TO BE APPROVED BY THE ENGINEER PRIOR TO INSTALLATION.

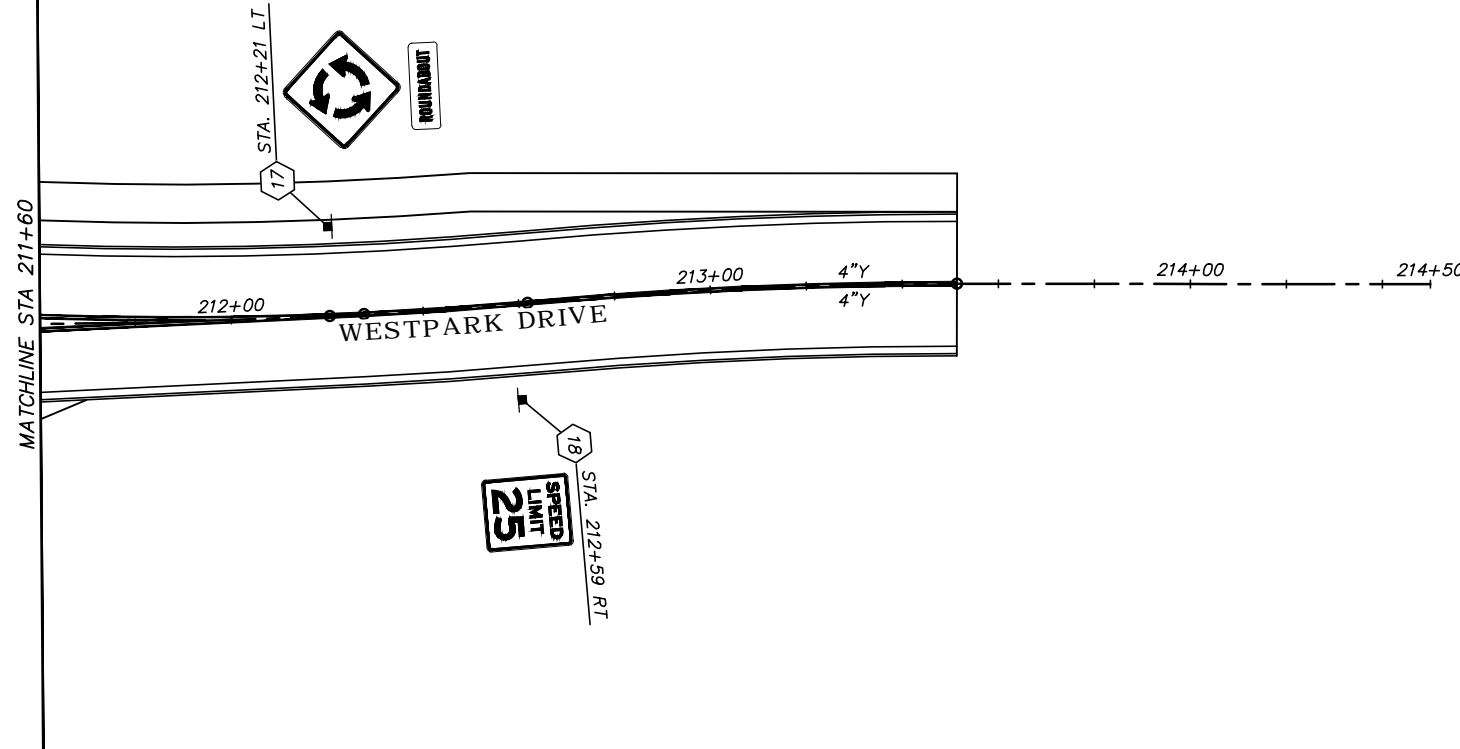

**BEFORE YOU DIG
CALL FOR FREE
UNDERGROUND
LOCATION**

LOCATE CALL CENTER OF ALASKA STATEWIDE 800-478-3121 WILL NOTIFY SUBSCRIBED UTILITIES ONLY. OTHER UTILITIES NEED TO BE CONTACTED INDIVIDUALLY.

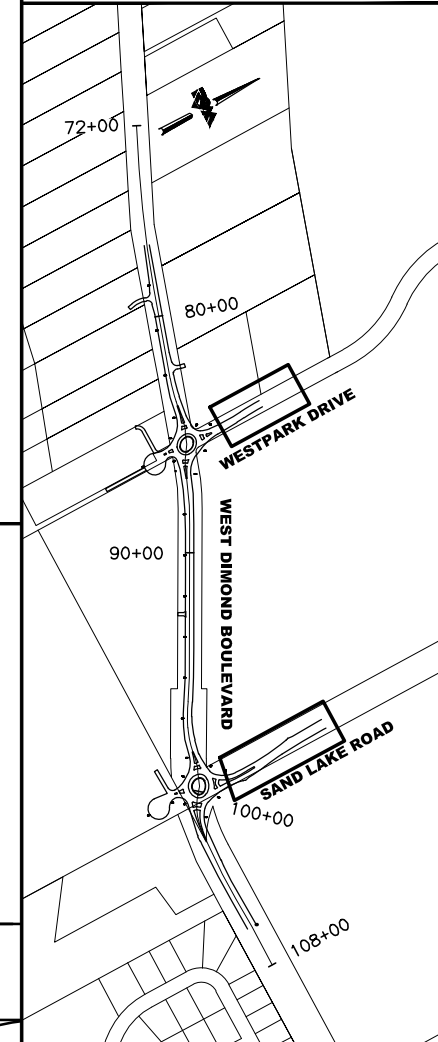

KEYMAP

**65% DESIGN
APRIL 2014**

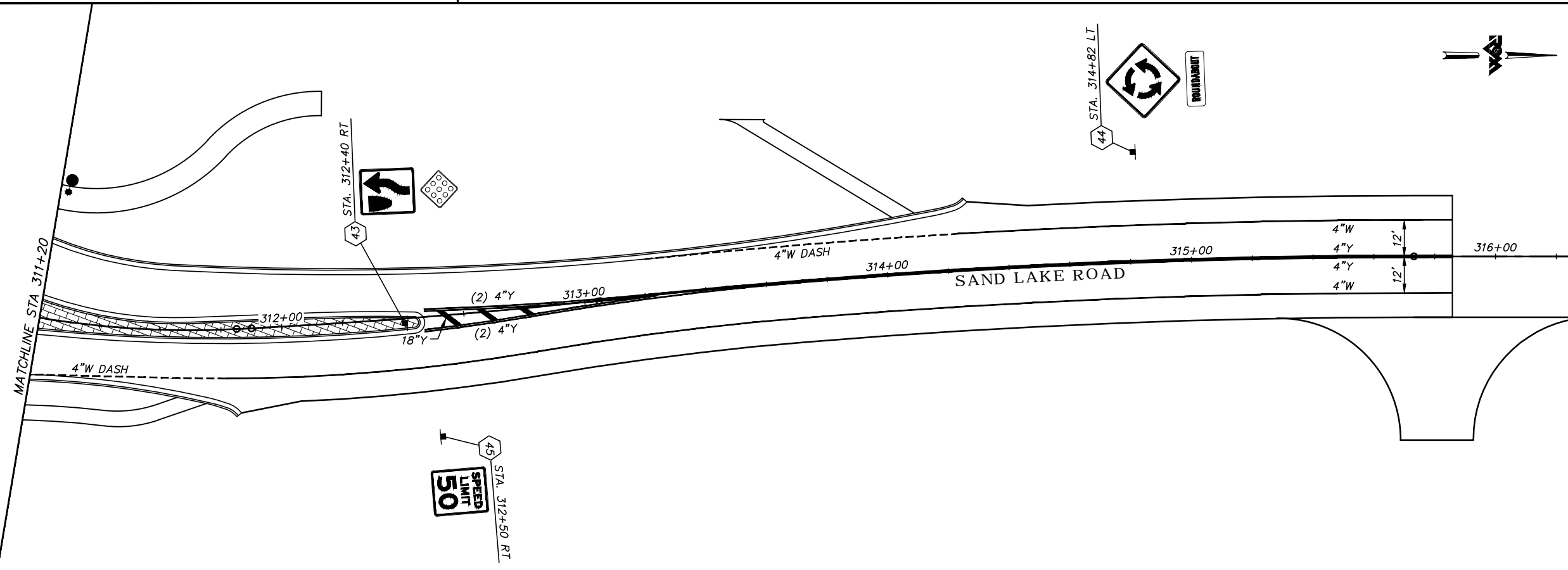

File Location: Z:\project\317.01- West Dimond Blvd\Engineering\Acad\317-L-Signing & Striping.dwg

Plotted: 4/11/2014 7:40 AM

FIELD BOOKS	BM NO.	LOCATION	ELEV.	DATA	DRAWN BY	CHECKED BY	DATA	DRAWN BY	CHECKED BY	REV	DATE	DESCRIPTION	BY	REV	DATE	DESCRIPTION	BY
DESIGN				BASE			TELEPHONE										
STAKING				TOPOGRAPHY			ELECTRIC										
ASBUILT				PROFILE			CABLE TV										
CONTRACTOR	BASIS OF THIS DATUM			SANITARY SEWER			DESIGN										
INSPECTOR				STORM SEWER			QUANTITIES										
CONSTRUCTION RECORD	VERTICAL DATUM			WATER			MUN. FINAL CHK.										
				GAS													

R&M Consultants, Inc.
9101 Vanguard Drive
Anchorage, Alaska 99507
907 522 1707 voice
907 522 3404 fax
www.rmconsult.com



**PROJECT MANAGEMENT AND
ENGINEERING DIVISION**

05-05 WEST DIMOND BOULEVARD UPGRADE
PHASE I: WESTPARK DRIVE TO SAND LAKE ROAD
SIGNING & STRIPING PLAN
WESTPARK DR & SAND LAKE RD

SCALE 1:20 H
1:4 V DATE ACCT. NO. GRID 2323 2324
2423 2424 SHEET 67 of 76

File Location: Z:\project\1317.01 - West Dimond Blvd\Engineering\Acad\1317-L-Signing & Striping.dwg

Plotted: 4/11/2014 10:49 AM

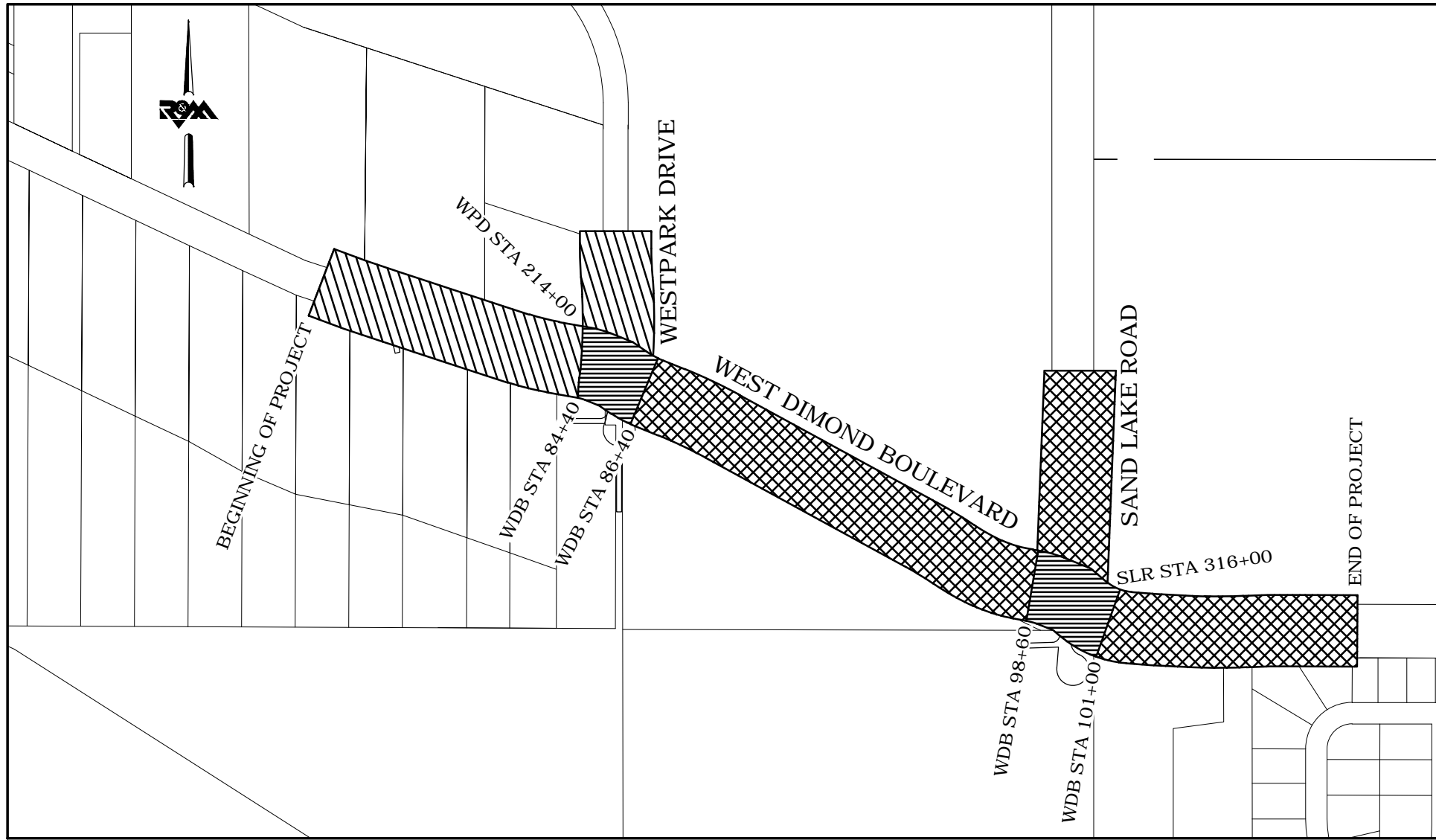

STRIPING MATERIALS LEGEND:

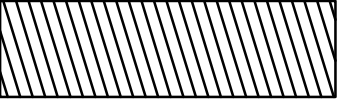
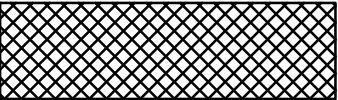
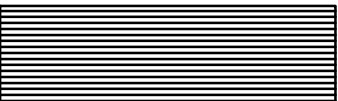
-  INLAID MMA 90 MILS
-  INLAID MMA 125 MILS
-  INLAID MMA 500 MILS

STRIPING MATERIALS AND APPLICATION KEY MAP

**65% DESIGN
APRIL 2014**

FIELD BOOKS	BM NO.	LOCATION	ELEV.	DATA	DRAWN BY	CHECKED BY	DATA	DRAWN BY	CHECKED BY	REV	DATE	DESCRIPTION	BY	REV	DATE	DESCRIPTION	BY
				BASE			TELEPHONE										
				TOPOGRAPHY			ELECTRIC										
				PROFILE			CABLE TV										
				SANITARY SEWER			DESIGN										
				STORM SEWER			QUANTITIES										
				WATER			MUN. FINAL CHK.										
				GAS													
CONSTRUCTION RECORD		VERTICAL DATUM					PLAN CHECK										REVISIONS



R&M Consultants, Inc.
9101 Vanguard Drive
Anchorage, Alaska 99507
907 522 1707 voice
907 522 3404 fax
www.rmconsult.com



PROJECT MANAGEMENT AND
ENGINEERING DIVISION

05-05 WEST DIMOND BOULEVARD UPGRADE
PHASE I: WESTPARK DRIVE TO SAND LAKE ROAD
STRIPING MATERIALS AND APPLICATION
KEY MAP

SCALE	DATE	GRID	2323 2324 2423 2424	SHEET 68 of 76
	ACCT. NO.			

SIGN SUMMARY																		
SHEET SUMMARY	POST NUMBER	ALIGNMENT	EXISTING SIGN LOCATION		RELOCATED OR NEW SIGN LOCATION		TYPE	LEGEND	SIZE WxH (IN)	STANDARD SIGN AREA (FT ²)	FRAMED	SIGN FACES	THICKNESS	POST SIZE NO., SIZE TYPE	NEW SIGN	RELOCATE EXISTING SIGN	SALVAGE SIGN	REMARKS
			STATION	OFFSET	STATION	OFFSET									(EACH)	(EACH)	(EACH)	
SUBTOTAL THIS SHEET										NEW SIGN (SF)	(EACH)	(EACH)	(EACH)					

TO BE COMPLETED

65% DESIGN
APRIL 2014

FIELD BOOKS	BM NO.	LOCATION	ELEV.	DATA	DRAWN BY	CHECKED BY	DATA	DRAWN BY	CHECKED BY	REV	DATE	DESCRIPTION	BY	REV	DATE	DESCRIPTION	BY
DESIGN				BASE			TELEPHONE										
STAKING				TOPOGRAPHY			ELECTRIC										
ASBUILT				PROFILE			CABLE TV										
CONTRACTOR				SANITARY SEWER			DESIGN										
INSPECTOR				STORM SEWER			QUANTITIES										
CONSTRUCTION RECORD				WATER			MUN. FINAL CHK.										
				GAS													
VERTICAL DATUM				PLAN CHECK				REVISIONS				CONSULTANT					



R&M Consultants, Inc.
9101 Vanguard Drive
Anchorage, Alaska 99507
907 522 1707 voice
907 522 3404 fax
www.rmconsult.com



PROJECT MANAGEMENT AND ENGINEERING DIVISION			
05-05 WEST DIMOND BOULEVARD UPGRADE PHASE I: WESTPARK DRIVE TO SAND LAKE ROAD			
SIGN SUMMARY TABLE			
SCALE	DATE	GRID	2323 2324 2423 2424
	ACCT. NO.		SHEET 69 of 76